

It's recommended to use a soft cloth or gloves when handling the fixture.

Wiring Instructions

1. Attach universal crossbar to J-box, aligning holes in regard to fire plate holes and fixture direction.
2. Connect positive supply wire (typically black or the smooth, unmarked side of the two-conductor cord) to positive fixture lead with appropriately sized twist on connector.
3. Connect negative supply wire (typically white or the ribbed, marked side of the two-conductor cord) to negative fixture lead.
4. Please refer to the grounding instructions to complete all electrical connections.
5. Tuck the connected wires into the J-box. Align screws from fire plate to the holes in universal crossbar.
6. Screw fire plate onto universal crossbar.
7. Connect backplate/reflector to fire plate using side screws, tightening the canopy flush to the ceiling.

Grounding Instructions

For positive grounding in a 3-wire electrical system, fasten the fixture ground wire (typically copper or green plastic coated) to the fixture mounting crossbar with the ground screw.

Note: On straps for screw support fixtures, first install the two mounting screws in strap. Any remaining tapped hole may be used for the ground screw.

Light bulb Replacement

1. Turn glass globes over reflector to reveal LED bulb.
2. Remove bulb by gently pulling it from socket and release from inner frame.
3. Turn globe back in place fitting over reflector

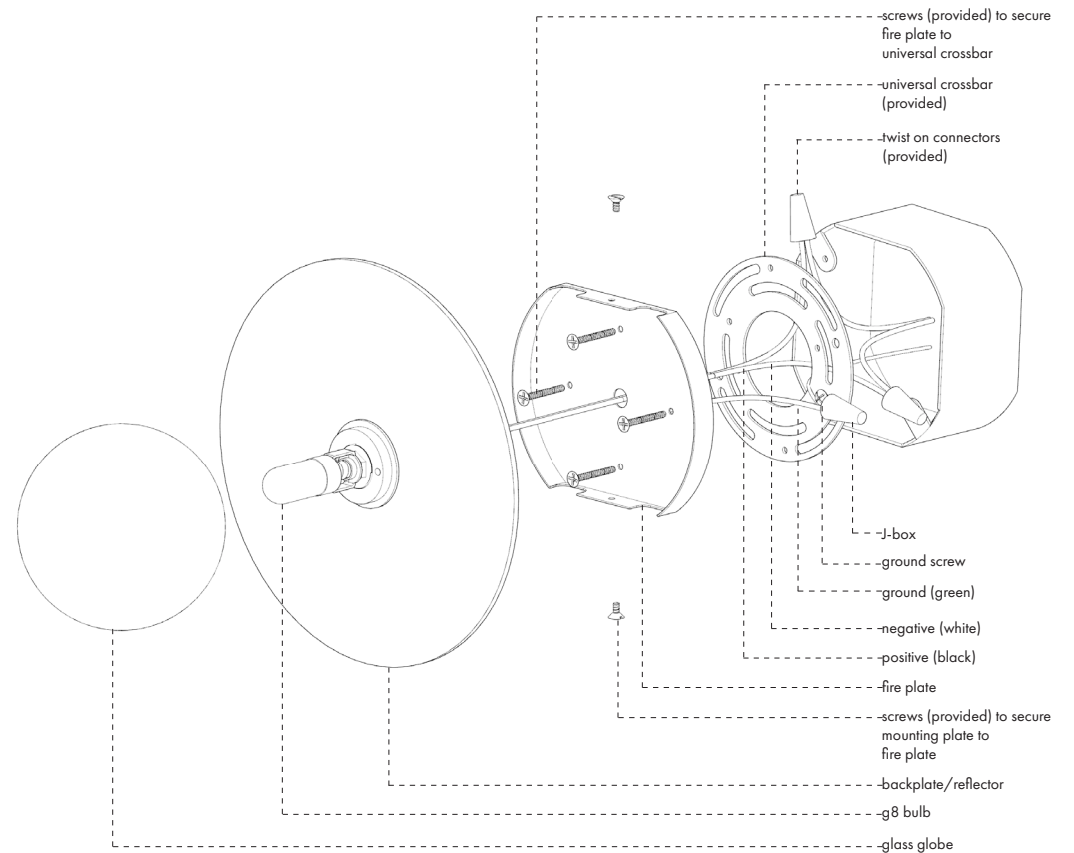

It's recommended to use a soft cloth or gloves when handling the fixture.

Wiring Instructions

1. Attach mounting plate to J-box using screws provided, aligning holes in regard to fixture direction.
2. Connect positive supply wire (typically black or the smooth, unmarked side of the two-conductor cord) to positive fixture lead with appropriately sized twist on connector.
3. Connect negative supply wire (typically white or the ribbed, marked side of the two-conductor cord) to negative fixture lead.
4. Please refer to the grounding instructions to complete all electrical connections.
5. Tuck the connected wires into the J-box. Align screws from mounting plate to the holes of the backplate.
6. Connect backplate to mounting plate using side screws, tightening the fixture-flush to the wall.
7. Insert bulb by gently pushing it into the socket centered on the backplate.
8. Gently rotate glass shade clockwise to secure to backplate.

Grounding Instructions

For positive grounding in a 3-wire electrical system, fasten the fixture ground wire (typically copper or green plastic coated) to the fixture mounting crossbar with the ground screw.

Note: On straps for screw support fixtures, first install the two mounting screws in strap. Any remaining tapped hole may be used for the ground screw.

Light Bulb Replacement

1. Turn glass globes over backplate to reveal LED bulb.
2. Remove bulb by gently pulling it from socket and release from the backplate
3. Turn globe back in place fitting over backplate.

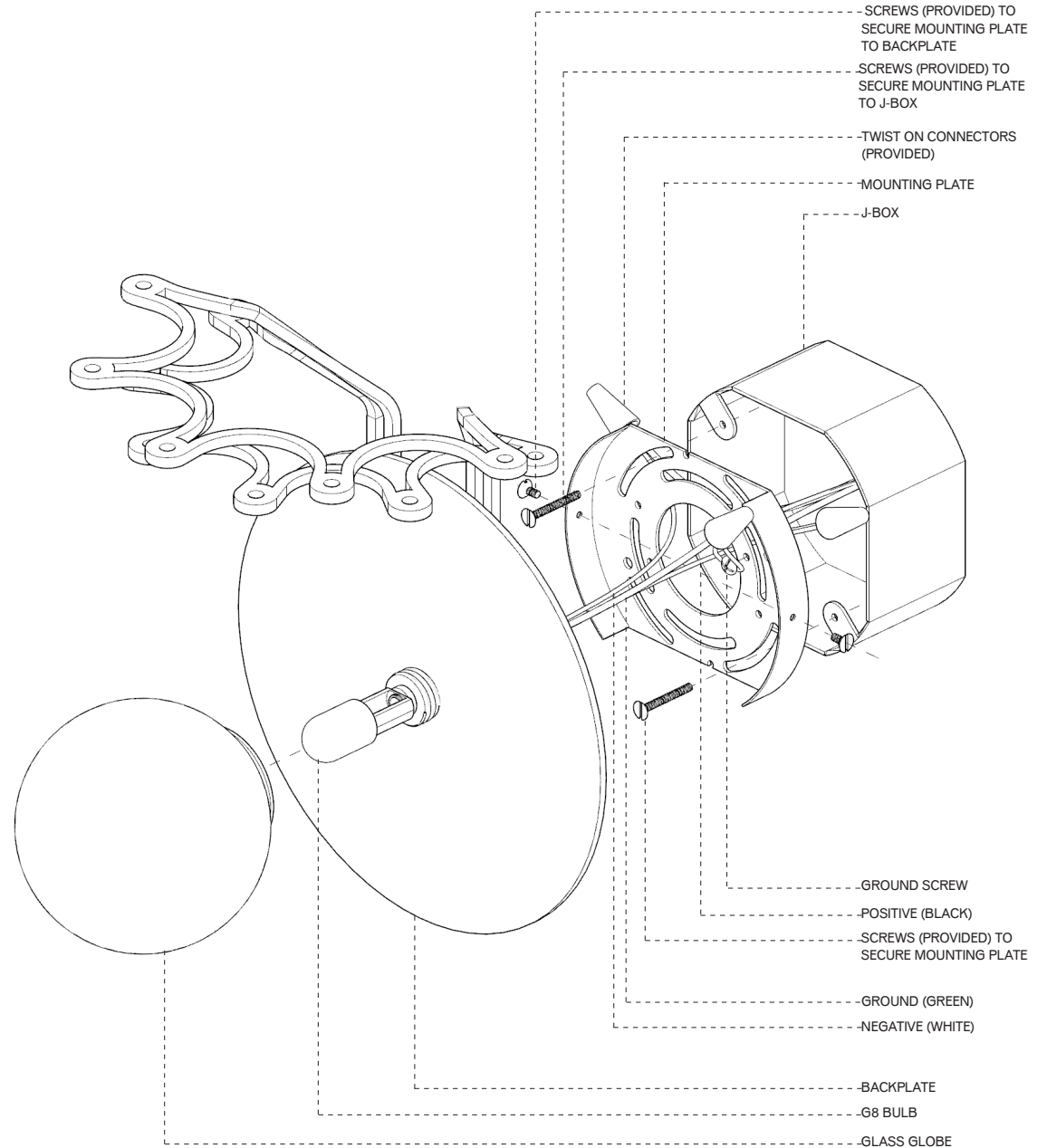

It's recommended to use a soft cloth or gloves when handling the fixture.

Assembly Instructions

1. Gently rotate glass shade clockwise to secure to backplate
2. Loosen provided set screws at wire stop.
3. Insert bottom frame into backplate at outer holes. Make sure wire stop is flush to top surface of backplate.
4. Secure (6) long beaded strands to bottom frame by pushing into position.
5. Insert top frame into backplate at inner holes about three-quarters of the way down the backplate, leaving some space between top and bottom frames.

See next page for steps 6-10.

Light bulb Replacement

1. Gently rotate glass shade counter clockwise to remove from fixture.
2. Remove bulb by pulling from socket and replace.
3. Rotate glass shade clockwise to secure to fixture. Do not over tighten.

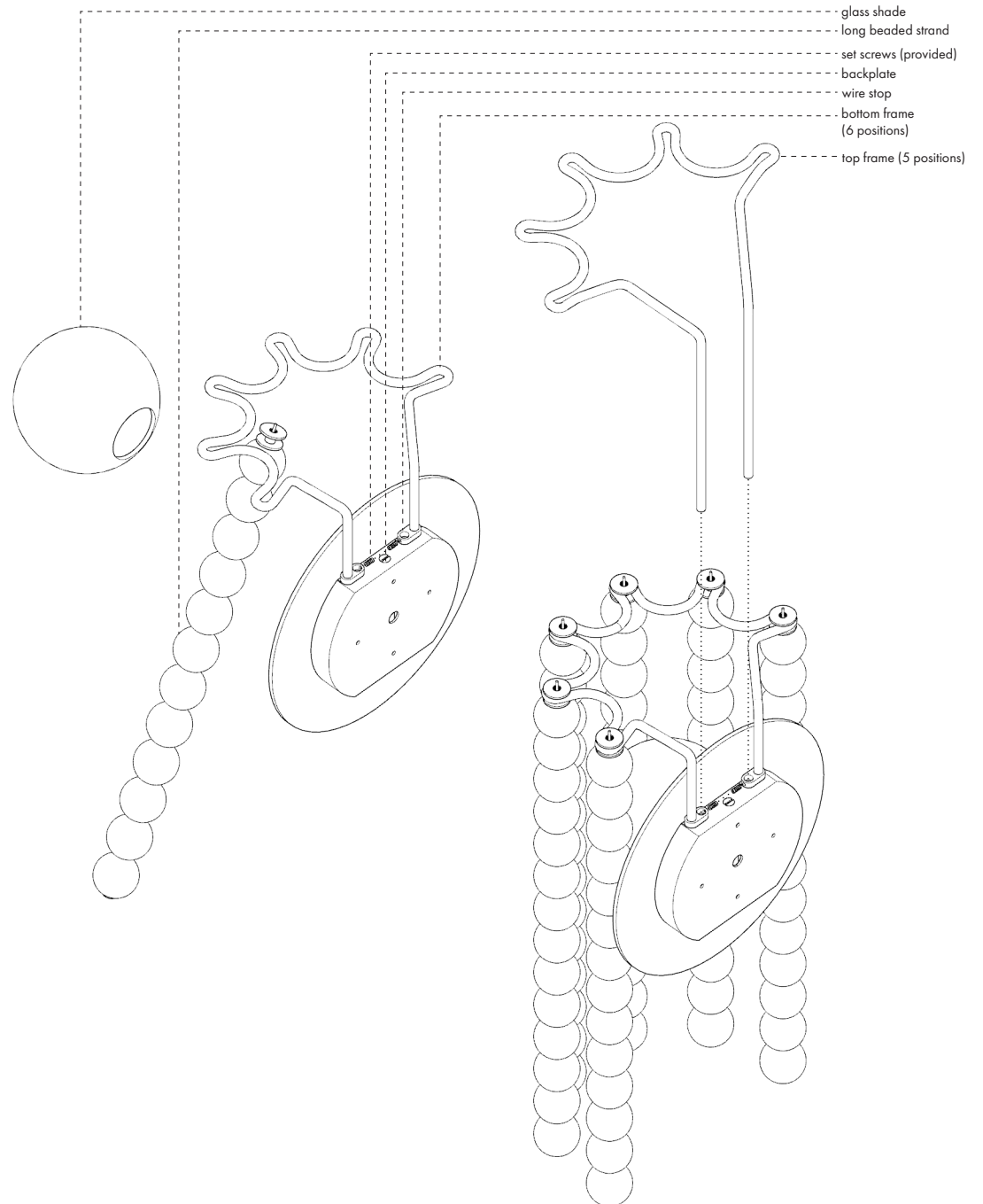

It's recommended to use a soft cloth or gloves when handling the fixture.

Assembly Instructions

1. Locate (6) long strands of beads. Confirm steel wire grip of each strand is secured on steel wire, with release tab visible. The release tab should sit slightly above the first bead at the top of the strand. Adjust if needed, refer Diagram 1.
2. Position long strand so that the steel wire grip comes through the bottom frame. Refer to Diagram 2.
3. Use one hand to hold the strand in place and the other to fasten the final bead onto the steel wire grip.
4. Repeat step 3 to until all six (6) of the long beaded strands are secured to the bottom frame.

See next page for steps 5-8

Light Bulb Replacement

1. Gently rotate glass shade counter clockwise to remove from fixture.
2. Remove bulb by pulling from socket and replace.
3. Rotate glass shade clockwise to secure to fixture. Do not over tighten.

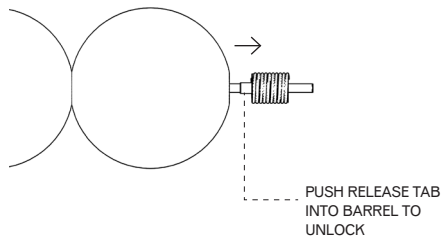

DIAGRAM 1: STEEL GRIP ADJUSTMENT

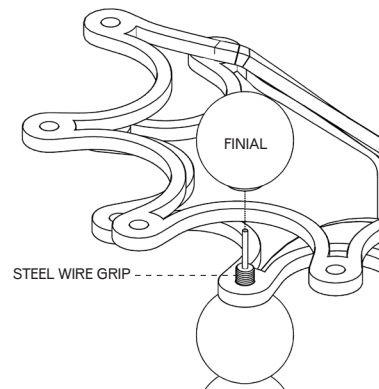
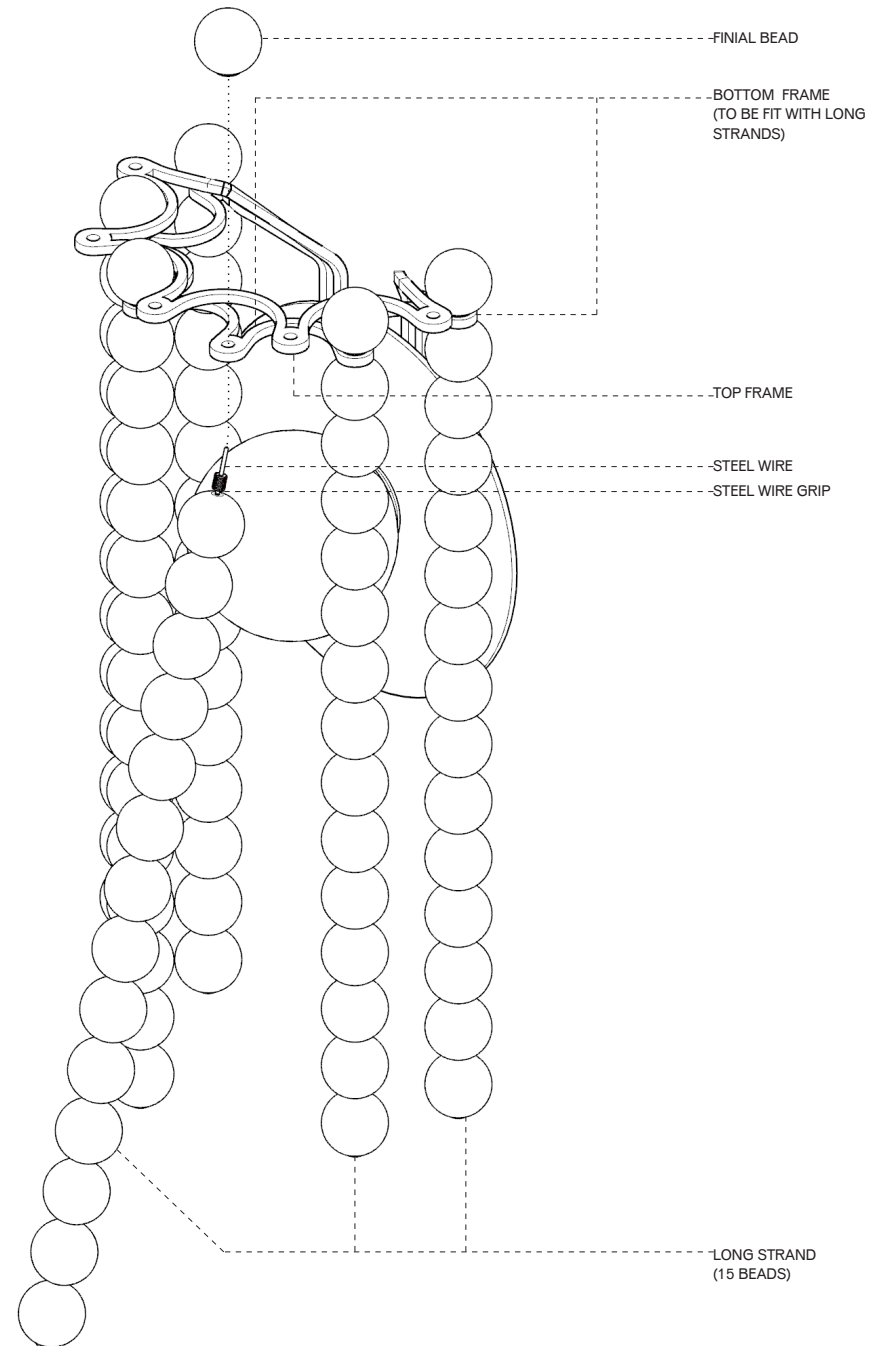

DIAGRAM 2: STEEL GRIP PLACEMENT



It's recommended to use a soft cloth or gloves when handling the fixture.

Assembly Instructions

- Secure (5) short beaded strands to top frame by pushing into position.
- Bring top frame completely down into backplate, until bottom of wire frame taps the bottom of the backplate.
- Tighten set screws with allen key to secure top frame.
- Rotate glass finial beads clockwise onto threaded hardware.

Light bulb Replacement

- Gently rotate glass shade counter clockwise to remove from fixture.
- Remove bulb by pulling from socket and replace.
- Rotate glass shade clockwise to secure to fixture. Do not over tighten.

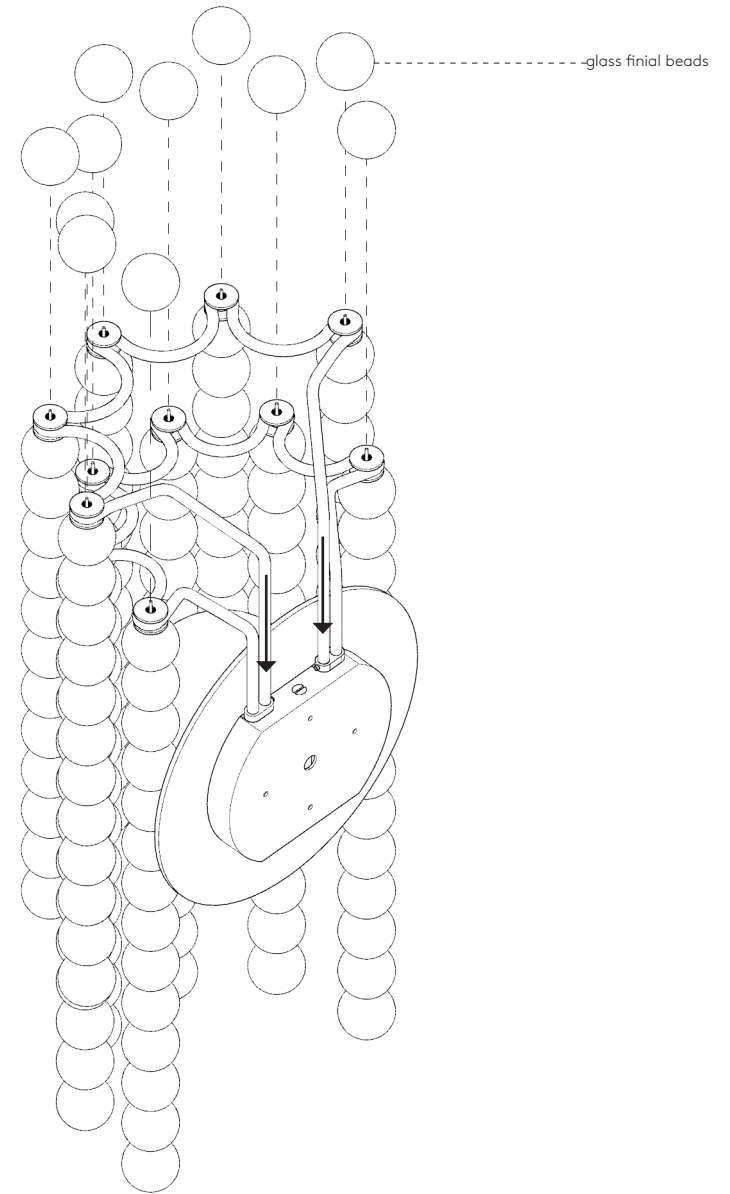

It's recommended to use a soft cloth or gloves when handling the fixture.

Assembly Instructions

5. Locate five (5) short strands of beads. Confirm steel wire grip of each strand is secured on steel wire, with release tab visible. The release tab should sit slightly above the first bead at the top of the strand. Adjust if needed, refer Diagram 1.

6. Position short strand so that the steel wire grip comes through the top frame. Refer to Diagram 2.

7. Use one hand to hold the strand in place and the other to fasten the final bead onto the steel wire grip.

8. Repeat step 7 to until all five (5) of the short beaded strands are secured to the bottom frame.

Light Bulb Replacement

1. Gently rotate glass shade counter clockwise to remove from fixture.

2. Remove bulb by pulling from socket and replace.

3. Rotate glass shade clockwise to secure to fixture. Do not over tighten.

